

Charitable Funds Committee

Tue 15 June 2021, 15:00 - 16:00

Teams

Agenda

15:00 - 15:00 **1. PRELIMINARY MATTERS**
0 min

- 1.1. Welcome and apologies
- 1.2. Declarations of interest

15:00 - 15:00 **2. ITEMS FOR APPROVAL/RATIFICATION/DECISION**
0 min

- 2.1. Bid for Approval: Health and Care Academy
 -  Charitable Funds Application - Health & Care Academy June 2021.pdf (13 pages)

15:00 - 15:00 **3. ITEMS FOR DISCUSSION**
0 min

There are no items for inclusion in this section

15:00 - 15:00 **4. ITEMS FOR INFORMATION**
0 min

There are no items for inclusion in this section

15:00 - 15:00 **5. OTHER MATTERS**
0 min

There are no items for inclusion

- 5.1. Date of next meeting:
23 September 2021

Jones, Shania
06/11/2021 15:26:29

PTHB Charitable Funds SBAR Form

Please choose who will benefit from this proposal (select all that apply):

PTHB Staff and Volunteers	<input checked="" type="checkbox"/>
PTHB Patients	<input checked="" type="checkbox"/>
Community	<input checked="" type="checkbox"/>
Other (specify below)	<input type="checkbox"/>

- Unpaid Carers
- Wider economy of Powys

Situation – Provide a brief summary of the proposal and outline what it aims to address. (max 200 words)

In December 2020, the Health and Care Academy Blueprint was endorsed by PTHB's Board. The ambition is clear; activating the Health and Care Academy Model will support the health and care sector in Powys to become the sector of choice, by growing the workforce through local training and education, skills development and leadership. This will be delivered through a hub and spoke model.

Although the Health Board has a responsibility for the development of its people, the ambition is above and beyond what the Health Board would be expected to deliver as its core responsibility for education and development.

To set the foundations for the Academy, some initial ICF investment has been received to develop a pilot hub site at Bronllys. This initial investment and core funding will enable the facility to open, however, to enhance the offer, the programme team are seeking funding from the Charitable Funds Committee to the value of **£180,000**, to ensure the hub has a significant impact on the education, training and the learning experience. The Charitable Funds bid has been refocused on **phase 1** of the approach only.

It is anticipated that by adopting this model the Health Board will be addressing some of its wider social responsibility, by starting to make an impact on the economic climate of the county through a wider education, training and development opportunity.

Background – Outline any relevant information that will provide context, including any previous proposals or projects. (max 750 words)

10/06/2021 15:26:29

The proposed Health and Care Academy model has been developed with partners across the sector through an Executive Steering Group, reportable to the Workforce Futures Programme Board, which acts as a key enabler of the 'Health & Care' strategy for Powys.

The concept of operating as a hub and spoke model across the county, offers a practical solution to the geographical footprint in Powys. It will offer modern, practical, academic and digital learning opportunities for staff, volunteers and carers. It will support local achievement of the aspirational health and care outcomes for the communities in Powys through in-service skills development, education and learning, and will have an important impact on the economy of Powys and Wales, by supporting improvements in employment opportunities.

We want to encourage the working population of Powys to see Health Care as the first option when thinking about their career. Adopting this approach is above and beyond what would be expected of the core business of the Health Board. With the right investment via Charitable Funds to provide digital learning directly to school aged children, we will widen career opportunities into Health Care.

There is a core requirement to deliver education, training and development across the health sector. The longer-term vision of the Academy offers us an opportunity to develop an **enhanced model, over and above** the core requirements, by enabling us to:

- Be an **exemplar provider of rural professional and clinical education**, by delivering an **integrated in-service training** offer that focuses on direct care, shared care and care delivered through digital;
- Be the **sector of choice** by growing the health and care workforce through skills development, education and local training, working with wider education providers and supporting the Welsh Language;
- Have a **Leadership talent operating at all levels**, compassionately working across systems, making a difference to the citizens and communities of Powys and empowering their teams to do so;
- Enable the workforce to **respond to people's needs in a timely way**, including our volunteers, paid and unpaid carers, through skills development and education opportunities.
- Be recognised as a **centre of excellence for research, development and innovation within Wales**, through trial and testing techniques; that includes a well-established industry relationship and supporting our core economy.

Work is underway to operationalise the Health and Care academy longer term which will ensure the model of working is sustainable into the future. However, the priority in **phase 1** is to capitalise on upfront ICF capital investment to begin the new model. This will enhance our current core education, training

Jones Gwyneth
06/11/2024 11:56:13

and development provision, as such the Charitable Funds bid has been refocused on phase 1 of the approach only.

Assessment – Please provide a detailed assessment of the available evidence with a view to addressing the problem. (max 750 words)

The investment from Charitable Funds will focus on the **hub pilot site physical space**, which will further enhance an innovative learning environment. It will deliver a learning experience that far exceeds the current model. This will be achieved through the following components:

- Innovative learning environment that attracts learners into the sector and engages the current workforce in CPD by offering state of the art simulated learning and interactive learning;
- Learning environments that digitally link to each other through the hub and spoke model, this ensures there is an equitable access across a large geographical county and supports better links with a range of Academic partners outside of county which is currently not available;
- An increased in-reach of education, training and development into county that prevents staff from having to take unnecessary journeys and opens the education offer to a wider range of participants.

The benefits of an enhanced offer supported by Charitable Funds will enable the enhanced interior at Basil Webb to be realised at pace, specifically focused on enhancing the ***interior of the physical space through latest technology and modern furnishings.***

Benefits of the Charitable Funds investment include supporting:

- the delivery of an environment that will support new ways of delivering Leadership development;
- the purchase of additional technology to provide an increased in-reach training, development and education offer across the sector;
- an enhanced environment that offers simulated/test and trial scenario-based learning space through the use of a modern training space;
- an environment where school children can attend (including virtual attendance) and learn about the sector and gain foundation skills which supports them to make informed career choices;
- a learning environment that enables access to an enhanced education, training and development for our carers and volunteers.

Jones, Sheng
06/11/2021 15:26:29

Recommendation – Detail your recommendation for the Charitable Funds Committee along with plans for evaluating the proposal and sustainability. (max 750 words)

An investment from Charitable Funds will take the academy from a training facility to being a flag ship building where our staff have access to education, through digital technology that is not currently available. This will enable the Health Board to utilise the facility for the development of carers and volunteers and more opportunities for school aged children to gain foundation skills, in a way that currently does not exist.

It will contribute to the requirements set out in the Future of Generations Act, which describes improving the economic, social, environmental and cultural well-being of Wales, by taking action through the lens of education and training.

Sustainability

In **Phase 1**, the programme will set the foundations of the Academy to include an Academy Hub building, offering a modern state-of-the-art learning environment. These foundations actively start to support improvements:

- **across the quality and development of new models of care;** ensuring the core business of the Academy is aligned to any transformational work underway across the health and care sector in Powys i.e. North Powys Wellbeing Programme
- **in health and wellbeing;** this specifically applies to the health and wellbeing of the workforce including volunteers and carers, by reducing the travel time the workforce has to travel to access some education, training and development outside of county. It also has an indirect impact on service users and patients who are being treated and cared for by a highly skilled, healthy, well workforce;
- **in the efficiency of services;** an enhanced education offer that supports the workforce to be more efficient and work at the top of their professional licence.

Further Academy development work will take place over the coming months to include activities such as:

- detailed 3-year plan for the Academy Model - A high level sustainability vision has been articulated in the health and care academy blueprint aligned to the organisational business plan. **NB a full detailed sustainability model will be included in the 3-year plan.**
- The development of a recognisable 'brand' and offer from the Academy, to enable people inside and outside of Powys to understand what the Academy has to offer;
- A clear programme of work for each of the 'School' areas, including demonstrable progress in enhancing the current core offer;

Jones, Shant
06/11/2021 14:26:29

- A well-established partnership approach to working with a wide range of provider organisations, supported by effective governance overseen by the Workforce Futures Programme Board;

Impact of Charitable Funds £180,000 investment

As this paper outlines, the initial upfront ICF investment and core funding alone will only be able to deliver a refreshed version of our core education, training and development. It will therefore not make the biggest impact on the learning environment/experience, neither will it make the significant impact we need on the economic climate of the county through a flagship hub site that could offer wider education, training and development opportunities.

However, with investment from Charitable Funds to enhance the pilot hub site, we will be able to deliver a **flagship hub site** with the ability to start to deliver over and above the current core education, training and development environment required by WG, the Denary, HEIW, Social Care Wales and professional groups, by supporting:

- the purchase of the **latest digital technology** enabling Powys to better link with partners inside and outside of county, increasing the in-reach of education and training into county and offer more research, innovation and improvement initiatives;
- the purchase of **modern furnishings** for the Hub that identifies the Academy's brand, supports an improved learning experience and creates environments that supports the health and wellbeing of the workforce;
- a significant impact on the communities in Powys through setting the foundations of a **wide range of accessible state-of-the-art facilities and digital equipment** currently unseen across Powys, which will provide upskilling solutions and wider access to education and career pathways into health and care.

The **risks** of Charitable Funds **NOT** investing include:

- An education environment that satisfies a core need, but is dated and delivers much of the same as before;
- Limited digital access to the environment for those who live a little further away, increasing travel and time spent getting to the hub;
- A continued limited access for carers and volunteers, who sometimes struggle to access skills updates and training;
- Limited ability to welcome school aged children into the health and care learning environment to gain foundation skills and knowledge.

The visuals below illustrate the difference between a Charitable Fund's investment.

Jones-Shanley
06/11/2023 15:29

Visual 1 - No Charitable Funds investment: illustrating the type of reusable education, training and development furnishings and IT kit we would see moved into Basil Webb, the academy hub pilot site.

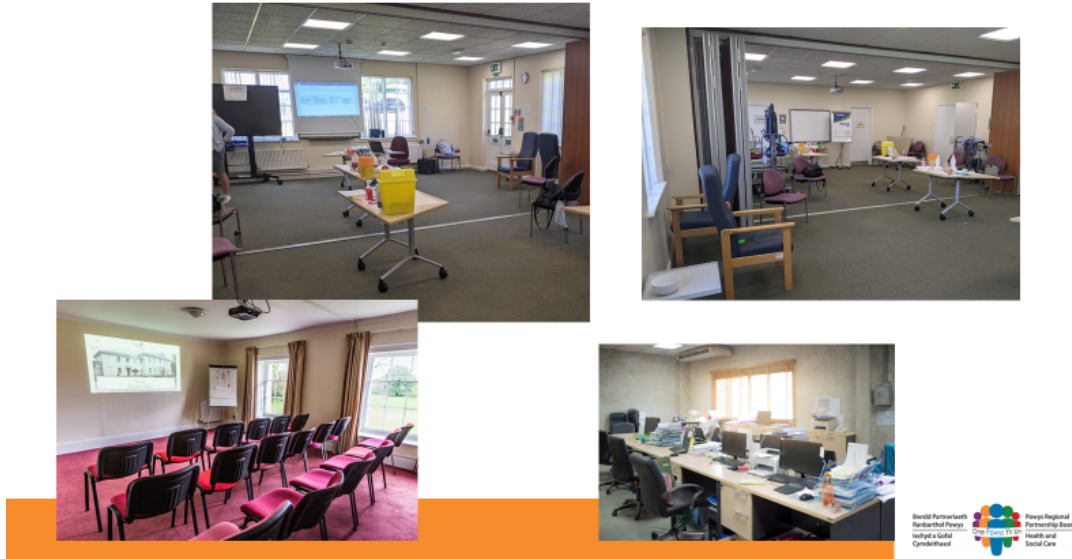

Visual 1- no charitable funds investment

Visual 2 - With Charitable Funds investment: illustrating an enhanced learning environment supported by the purchase of state-of-the-art IT technology, gadgets and furnishings, a flag ship facility.

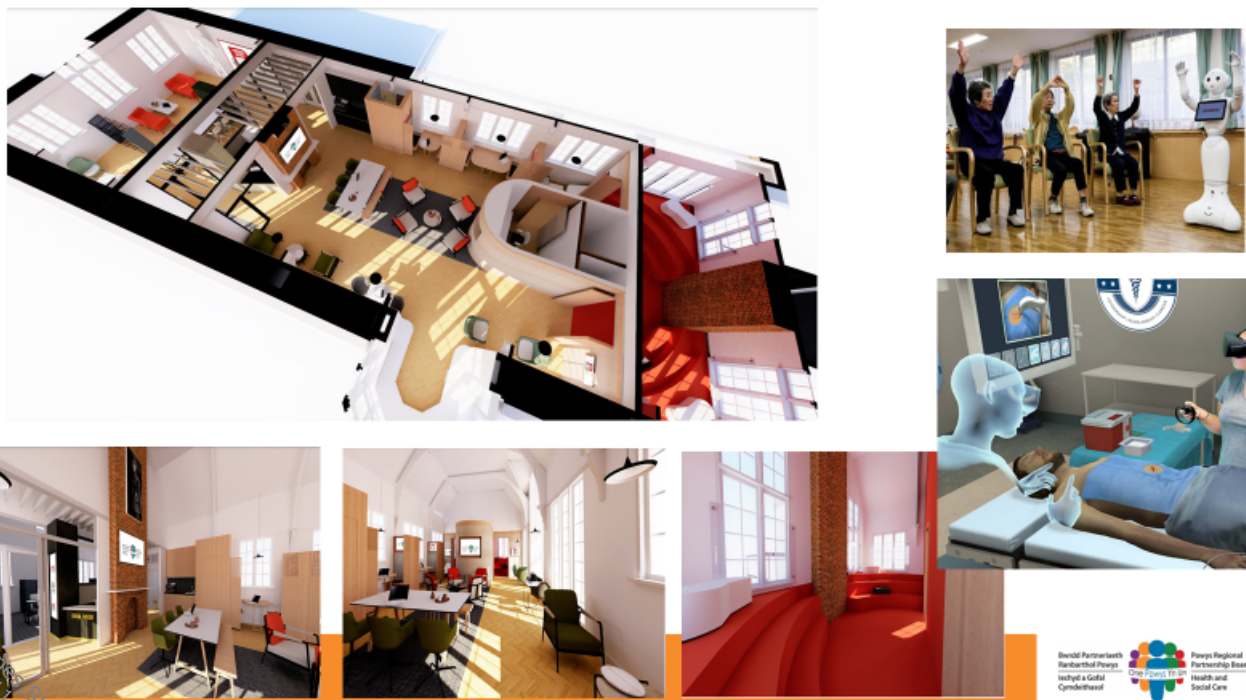

Visual 2 – with charitable funds investment

Yvonne
 06/12/2021 15:26:29

Resources - Try to provide a detailed breakdown of the budget and resources required, including quantities and cost per item.

Investment request to Charitable Funds

The programme team are seeking **£180,000** of Charitable Funds to support **phase 1** of the programme of work. As described in this paper the funding will enhance the pilot hub site, enabling us to deliver a **flagship facility** with the ability to start to showcase a range of delivery over and above the current core education, training and development environment.

Cost analysis

There will be no change from the current revenue cost for phase 1, and it is not anticipated that there are any additional staffing or other revenue costs associated with the development of the academy at this time.

Following NHS tender procedures, we will be ensuring any Charitable Funds purchases are cost effective, and therefore have sought indicative costs from a variety of providers on the NHS procurement framework. Detailed

indicative costs for digital technology, IT solutions and modern furnishings from a range of providers can be found in the appendices. A summary of this can be found in *table 1 – charitable funds investment spend*. These costs would be firmed up on the confirmation of approval of charitable funds.

Health & Care Charitable Funds investment spend summary		
Furnishings & Equipment		Total
	Modern furnishings	£48,331.00
	Wall mounted IT kit	£116,000.00
	Handheld mobile IT kit	£15,068.60
	Total	£179,399.60*
		*NB includes VAT

Table 1 – Charitable funds investment spend

The upfront capital costs and revenue costs (cost neutral) over the next 2 years for the Academy hub pilot site at Bronllys are illustrated in *table 2 – Academy hub pilot site costs*. There will be no anticipated additional revenue costs as part of this phase of work, therefore **no risk** to charitable funds for their investment.

Academy capital/revenue summary	Year 20/21 '£000	Year 21/22 '£000	Year 22/23 '£000	Comments
Capital funding	£446,000*	£126,000**	£0	*To develop Basil Webb, includes core furnishings ** allocated for the conversion of the bungalow into an adaptive living space
Revenue costs	£0***	£0***	£0	***No additional anticipated revenue cost/ cost neutral within existing budgets
Sub-Total	£446,000	£126,000	£0	

Table 2 – Academy Hub pilot site costs

Contact details

Name: Julie Rowles- Director of Workforce, OD and Support Services Louise Richards, Joint Health and Care Strategic Workforce Planning Manager

Email address: Julie.Rowles@wales.nhs.uk
louise.k.richards@wales.nhs.uk

Phone number: 07779154838

Delivery address (if applicable):



Declaration

I have read the PTHB Charitable Funds staff guidance document.	<input checked="" type="checkbox"/>
I have read the FCP (INTERIM) – COVID 19 Decision Making & Financial Governance document found here .	<input checked="" type="checkbox"/>
I confirm that this funding will only be used for the purposes specified in this application.	<input checked="" type="checkbox"/>

Applicant

Name: Louise Richards
Planning Manager
Signature:

Role: Joint Strategic Workforce
Date:

Approving manager/executive

Name: Julie Rowles
and Support Services
Signature:

Role: Director of Workforce, OD
Date:

Please email this completed form to abe.sampson@wales.nhs.uk



Appendix

1.IT kit Investment

Visavvi	Cost	Total
Reception		
ONELAN NTB-4K-1000-S Digital signage player with ultra High-Definition payout	£1,053.58	£2,107.16
Peerless-AV SF650P SmartMount® Universal Flat Mount for 39" - 75" Flat Panel Screens	£50.76	£50.76
Peerless-AV SFP680 SmartMount® Universal Flat Wall Mount for Portrait Orientation	£120.57	£120.57
Philips 50BFL2114/12 50" Business TV, 4K UHD,	£564.32	£564.32
Philips 65BDL3050Q/00 Philips 65" Direct LED 4K Display,	£830.08	£830.08
Visavvi Cable SCSR Small room site cables, connectors & consumables	£113.33	£113.33
Library		
2 x APart COLW101 10 x 3.3" sound column speaker	£259.76	£519.52
Crestron AM-200 AirMedia® Presentation System 200	£910.59	£910.59
Crestron RMC3 3-Series® Room Media Controller	£505.88	£505.88
Crestron UC-CX100-T Crestron Flex Advanced Video Conference System Integrator Kit for	£3,370.59	£3,370.59
Extron NetPA U 1002 Two Channel Dante Amp, 100 watts at 8 or 4 ohms	£742.35	£742.35
Netgear GS418TPP-100EUS 16P GE POE+ SMART MANAGED PRO SWITC	£313.30	£313.30
Peerless-AV PT660 Peerless Pro Universal Tilt Wall Mount for 39" - 90" Flat Panel Screens	£60.28	£60.28
Philips 86BDL3050Q/00 Philips 86" Direct LED 4K Display	£2,785.96	£2,785.96
QSC CORE NANO Network Core	£1,301.47	£1,301.47
QSC PTZ-12x72 Q-SYS PoE camera for AV-to-USB Bridging.	£2,801.47	£2,801.47
QSC PTZ-20x60 Q-SYS PoE camera for AV-to-USB Bridging	£3,339.71	£3,339.71
2 x QSC PTZ-WMB1 Accessory Wall Mount Bracket for PTZ Camera	£92.65	£185.30
QSC SL-MST-8N-P Q-SYS Core 8 Flex, Core Nano, NV-32-H (Core Capable) license for Microsoft	£191.92	£191.92
Quadra CEQPTRAY Wall mounted sliding rack.	£119.04	£119.04
2 x Shure MXA710W-4FT LINEAR ARRAY, WHITE, 4 FEET	£1,894.12	£3,788.24
Visavvi Cable SCMR Medium room site cables, connectors & consumables	£465.33	£465.33
Booths		
4 x Crestron AM-200 AirMedia® Presentation System 200	£910.59	£3,642.36
4 x Philips 32BDL3010Q/00 Philips 32" Q-Line, 18/7, FHD,	£238.58	£954.32
4 x UNICOL TVV1B Tevella TV stand	£100.53	£402.12
2 x Visavvi Cable SCSR Small room site cables, connectors & consumables	£113.33	£226.66
Flexible Area		
2 x APart COLW101 10 x 3.3" sound column speaker	£259.76	£519.52
Crestron AM-200 AirMedia® Presentation System 200	£910.59	£910.59
Crestron RMC3 3-Series® Room Media Controller	£505.88	£505.88
Microsoft Teams®	£3,370.59	£3,370.59
Extron DTPHDMI 230RX HDMI Twisted Pair Receiver - 230 feet (70 m)	£184.71	£184.71
Extron DTP T HD2 4K 230 HDMI Twisted Pair Transmitter with Input Loop-Through - 230 feet (70 m)	£347.06	£347.06
Extron NetPA U 1002 Two Channel Dante Amp, 100 watts at 8 or 4 ohms	£742.35	£742.35
Netgear GS418TPP-100EUS 16P GE POE+ SMART MANAGED PRO SWITC	£313.30	£313.30
2 x Peerless-AV SF650P SmartMount® Universal Flat Mount for 39" - 75" Flat Panel Screens	£50.76	£101.52
2 x Philips 65BDL3050Q/00 Philips 65" Direct LED 4K Display	£830.08	£1,660.16
QSC CORE NANO Network Core, 64x64 network I/O channels with 8x8 Software-based Dante license included, USB AV bridging, dual LAN ports, VoIP telephony, 8 AEC processors, Half-size 1RU.	£1,301.47	£1,301.47
QSC PTZ-12x72 Q-SYS PoE camera for AV-to-USB Bridging.	£2,801.47	£2,801.47
QSC PTZ-20x60 Q-SYS PoE camera for AV-to-USB Bridging	£3,339.71	£3,339.71
2 x QSC PTZ-WMB1 wall mounted bracker for PTZ camera	£92.65	£185.30
QSC SL-MST-8N-P Q-SYS Core 8 Flex, Core Nano, NV-32-H (Core Capable) license for Microsoft	£191.92	£191.92
Quadra CEQPTRAY Wall mounted sliding rack.	£119.04	£119.04
2 x Shure MXA710W-4FT LINEAR ARRAY, WHITE, 4 FEET	£1,894.12	£3,788.24
Visavvi Cable -SCMR Medium room site cables, connectors & consumables	£465.33	£465.33

06/11/2021 15:26:29
Shania



Hydra Minerva Suite		
4 x Philips 32"	£238.58	£954.32
4 x UNICOL SSV Double swing arm mount	£83.53	£334.12
4 x Visavvi 1G-HDMI Wall Plate with HDMI input, white	£35.71	£142.84
Visavvi Cable SCMR Medium room site cables, connectors & consumables	£465.33	£465.33
Plenary		
Microsoft Surface Hub 2s 85"	£17,915.83	£17,915.83
Microsoft EHS: Srfc Hub 2S 85" 3YR service plan	£4,269.00	£4,269.00
Steelcase Roam Floor Mount - 85"	£1,279.00	£1,279.00
Poly 7200-85830-102 - USB soundbar	£703.00	£703.00
Poly 4870-85830-112 - Premier Care, Polycom Studio One Year	£74.00	£74.00
Poly 7230-86040-001 - Polycom Studio Display Mounting Kit,	£120.00	£120.00
Visavvi SYSDDELVC85 - Wall mount	£275.00	£275.00
Visavvi Cable -SCMR - Medium room site cables, connectors & consumables	£465.33	£465.33
Professional Services		
Delivery charge	£150.00	£150.00
Remote assistance	£1,000.00	£1,000.00
10 x Installation	£740.00	£7,400.00
2 x Project management	£520.00	£1,040.00
2 x System drawings	£260.00	£520.00
Commissioning	£370.00	£370.00
System design	£450.00	£450.00
2 x DSP Programming	£1,000.00	£2,000.00
Advance control system programming	£1,740.00	£1,740.00
Training	£650.00	£650.00
Hub training	£1,000.00	£1,000.00
Cost		£94,578.56
VAT	20% VAT	£18,915.71
Total Cost		£113,494.27
This quote does not include handheld devices or pc's		

Jones, Shania
06/11/2021 15:26:29

2. Modern Furnishing quote

Item	Location	Quantity	Supplier	Item No	Cost each	Total Cost
Sofa		4				
(A&C)	Library	2	Ministry of furniture	Herb 2 person sofa	£650.00	£1,300.00
(X, BB)	Flexible space	2	Momentum	Fully upholstered 3 seat, modular sofa	£1,666.00	£3,332.00
Rectangle table		2				
(B)	Library	1	Ministry of furniture	Herb Coffee Table	£260.00	£260.00
(AA)	Flexible space	1	Ministry of furniture	Herb Coffee Table	£260.00	£260.00
Lounge chair		15				
(E,G,M,N,P)	Library	6	Sphere interiors	Connection Rollie Chair	£341.00	£2,046.00
	Flexible space	5	Sphere interiors	Connection Rollie Chair	£341.00	£1,705.00
(S,T,U,Z, CC,DD,FF,HH,JJ)	Flexible space	4	Momentum	Lounge chair high back,	£940.00	£3,760.00
Round table		6				
(F,O)	Library	3	Sphere interiors	Frovi wire coffee table	£260.00	£780.00
(V, EE, WS)	Flexible space	3	Sphere interiors	Frovi wire coffee table	£260.00	£780.00
High Table & Chairs		3				
	Library	2	Sphere interiors	Frovi Relic High Table, Frovi Scandi High Stool	£2,612.00	£5,224.00
	Flexible space	1	Sphere interiors	Frovi Relic High Table, Frovi Scandi High Stool	£1,706.00	£1,706.00
Free standing, moveable bookcase (5m)		2				
(D&H)	Library	2			£1,456.00	£2,912.00
Desk chair		60				
	Throughout		Ministry of furniture	Arlo Stacking Conference Style Chair 4 Leg	£79.00	£4,740.00
	Trolley	1	Ministry of furniture	Heavy Duty Stacking Trolley	£459.00	£459.00
Lumbar chairs		4				
(Q,R)	Reception	2	Sphere interiors	Orangebox Do Mesh Back Task Chair	£253.00	£506.00
(K,L)	Minerva suite	2	Sphere interiors	Orangebox Do Mesh Back Task Chair	£253.00	£506.00
Miscellaneous						£10,000.00
Leaflet erack						
Shelving						
colour pallettes						
						£40,276.00
				Vat	20%	£8,055.20
				Total		£48,331.20

Jones, Shania
06/11/2021 15:26:29

3. Handheld IT kit quote



This solution allows safe / discreet charging storage of 12 tablet / Netbook devices.

Additional

Brackets
£585 + VAT

Handheld Devices – Microsoft Surface Go

Microsoft Surface Go 2 10.5" - Core M3 8100Y - 8 GB RAM - 128 GB SSD

Unit Price **£542.49**

Qty 20 Price **£10,849.80**

Microsoft Surface Go Type Cover Keyboard - With Trackpad, Accelerometer

Unit Price **£54.71**

Qty 20 Price **£1,094.20**

3 Year Complete for Business - Surface GO inc advanced repl & 2 x accidental damage incidents per device

Unit Price **£156.23**

Qty 20 Price **£3,124.60**

Desktop Computers – Dell OptiPlex 3070

Dell OptiPlex 3070

SFF - Core i5 9500 3 GHz - 8 GB - SSD 128 GB

Unit Price **£410.99**

Qty 4 Price **£1,643.96**

Desktop Monitor Dell P2419H

Dell P2419H LED monitor - Full HD (1080p) - 24"

Unit Price **£119.99**

Qty 4 Price **£479.96**

Dell Wireless Keyboard and Mouse

Dell Wireless Keyboard and Mouse - KM636

Unit Price **£28.50**

Qty 4 Price **£114.00**

Jones Shania
06/11/2021 15:26:29